

# 24"W 2-DRAWER / FILE DRAWER BASE CABINET

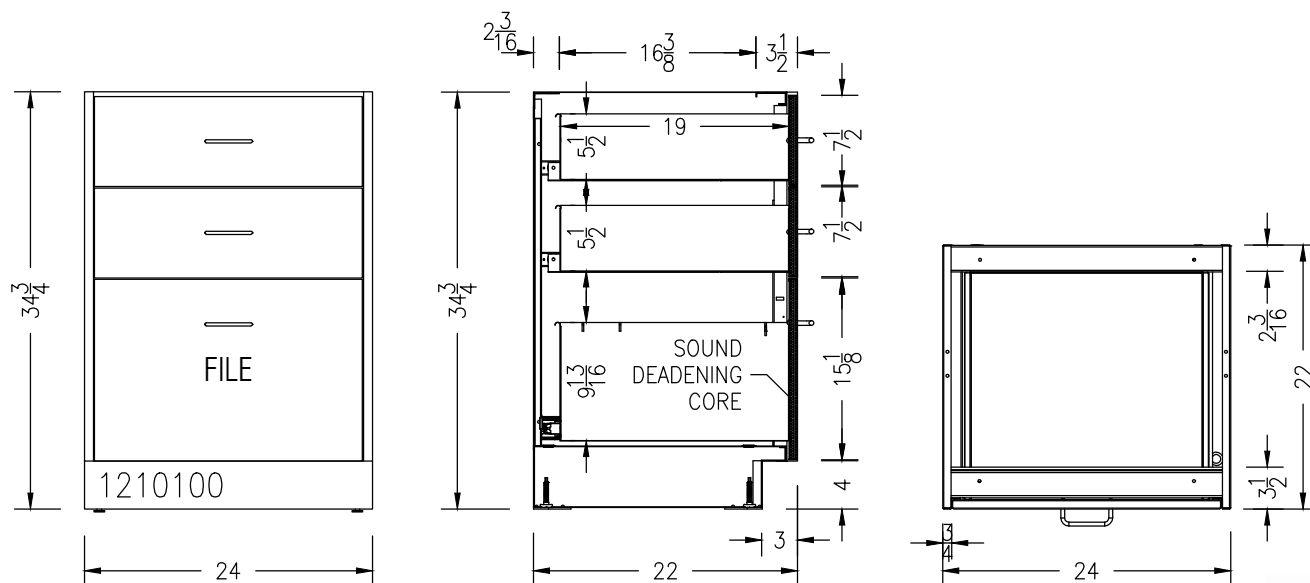

- DRAWER SLIDES:  $\frac{3}{4}$  EXTENSION 100 LB NYLON ROLLER SLIDES
- FILE DRAWER SLIDES: 200 LB BALL BEARING FULL-EXTENSION SLIDES
- ALUMINUM WIRE PULLS
- ADJUSTABLE LEVELING FEET WITH UP TO 1.5" OF ADJUSTMENT
- SOUND DEADENING CORE INSIDE DRAWER FRONTS
- COLOR: WARM GRAY

## CABINET GAUGES

20 GAUGE	DRAWER BODIES, DRAWER LINERS, REMOVABLE BACKS
18 GAUGE	CABINET GABLES, TOPS, BOTTOMS, TOEKICKS, OUTER DRAWER FRONT PANELS
16 GAUGE	TOP AND INTERMEDIATE CHANNELS, BASE CABINET REAR RAIL
14 GAUGE	DRAWER SUSPENSION, HINGE PLATES, BASE CABINET TOP RAIL
11 GAUGE	CABINET LEVELER SUPPORT



  
 online industrial & laboratory furniture  
 888.635.2949 | [NELdirect.com](http://NELdirect.com)

1210100

09/08/15