

# 58"W 2-DOOR END UNIT SINK BASE CABINET

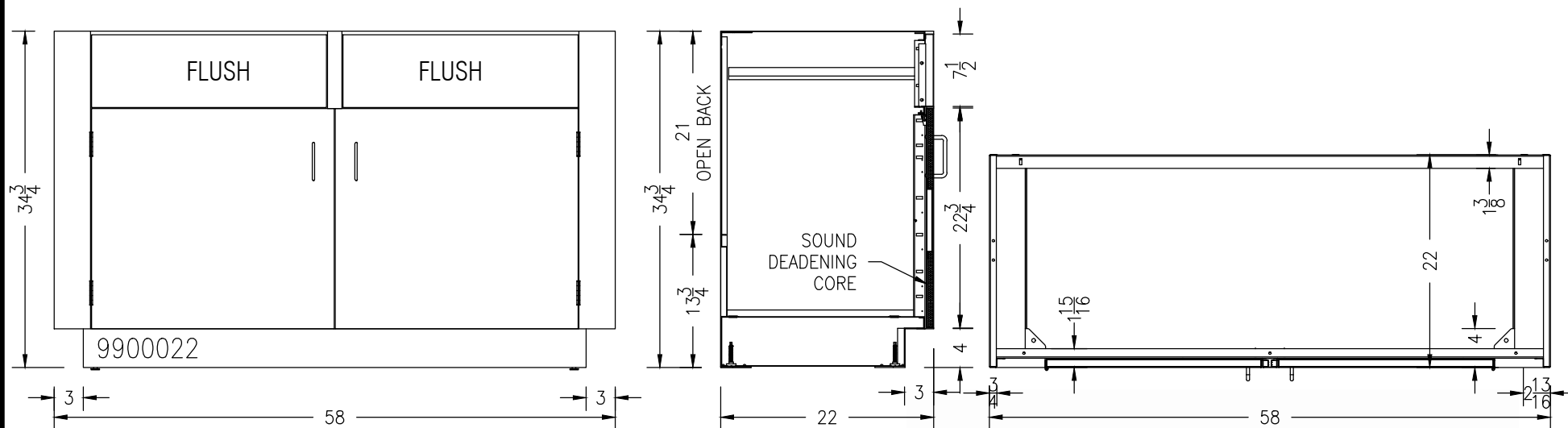

- NYLON ROLLER DOOR CATCH
- ALUMINUM WIRE PULLS
- STAINLESS STEEL 5-KNUCKLE HINGES
- ADJUSTABLE LEVELING FEET WITH UP TO 1.5" OF ADJUSTMENT
- SOUND DEADENING CORE INSIDE DOOR FRONTS
- GALVANIZED INTERIOR CABINET BODY
- COLOR: WARM GRAY

## CABINET GAUGES

20 GAUGE	DOOR LINERS, REMOVABLE BACKS
18 GAUGE	CABINET GABLES, TOPS, BOTTOMS, TOEKICKS, OUTER DOOR FRONT PANELS
16 GAUGE	TOP AND INTERMEDIATE CHANNELS, BASE CABINET REAR RAIL
14 GAUGE	HINGE PLATES, BASE CABINET TOP RAIL
11 GAUGE	CABINET LEVELER SUPPORT



**NEL direct**  
online industrial & laboratory furniture  
888.635.2949 | [NELdirect.com](http://NELdirect.com)

9900022

09/08/15



# WaterSaver

INNOVATIVE PRODUCTS FOR RESEARCH

**NEL** *direct.*  
online industrial & laboratory furniture  
888.635.2949 | [NELdirect.com](http://NELdirect.com)

WaterSaver Faucet  
701 W Erie St  
Chicago, IL 60654

312 666 5500 TELEPHONE  
312 666 5501 FACSIMILE  
[wsflab.com](http://wsflab.com)

## L414-8VB55

LABORATORY MIXING FAUCET, DECK MOUNTED, 8" RIGID/SWING VACUUM BREAKER GOOSENECK, AERATOR

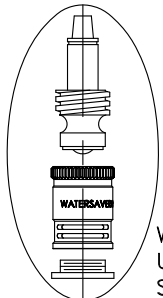
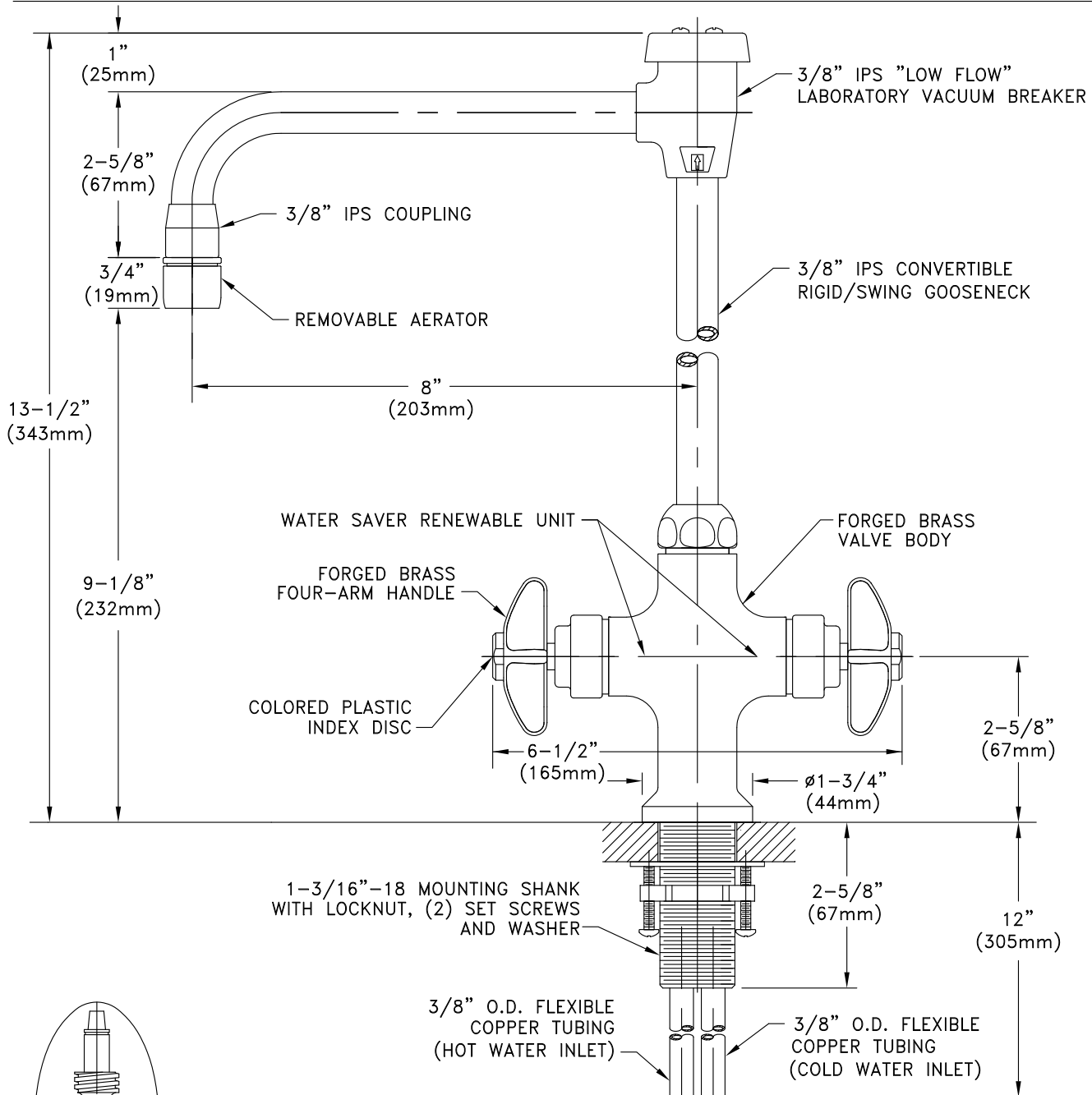

WATER SAVER RENEWABLE  
UNIT WITH REPLACEABLE  
STAINLESS STEEL SEAT

### NOTES:

1. FIXTURE IS FULLY ASSEMBLED AND FACTORY TESTED PRIOR TO SHIPMENT.
2. VACUUM BREAKER IS CERTIFIED TO COMPLY WITH ASSE 1001.
3. FIXTURE IS CERTIFIED BY CSA INTERNATIONAL TO COMPLY WITH ASME A112.18.1M AND CSA B125.1.
4. FIXTURE HAS A POLISHED CHROME PLATED FINISH.



MEASUREMENTS MAY VARY  $\pm 1/4$ " (6mm).

Drawing Number: \_\_\_\_\_

Revision Number: 122612-KJS

# DURCON<sup>TM</sup> INCORPORATED

**NEL** *direct*  
online industrial & laboratory furniture  
888.635.2949 | [NELdirect.com](http://NELdirect.com)

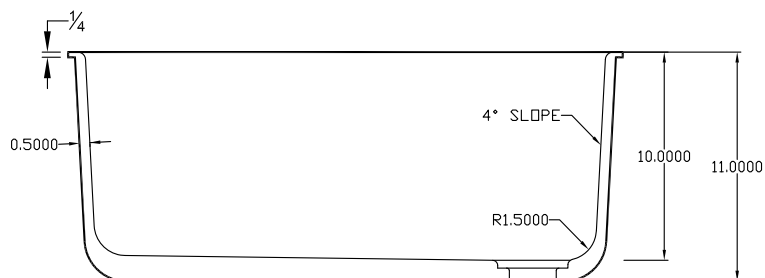

SECTION VIEW

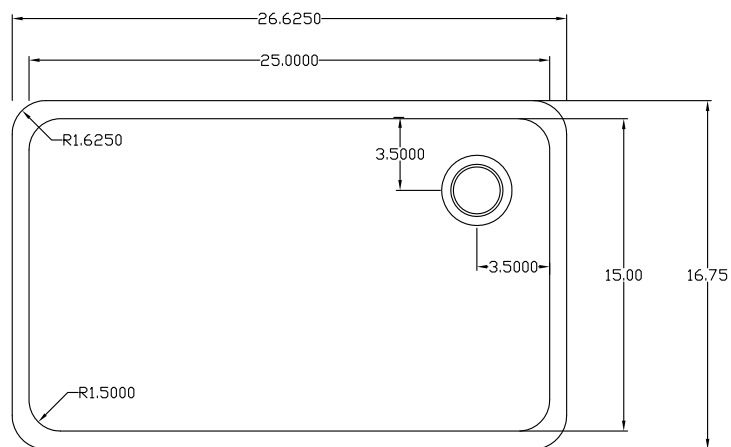

TOP VIEW

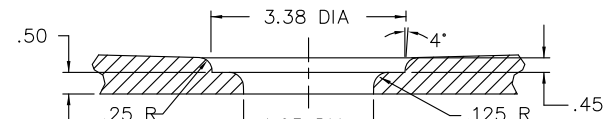

DRAIN OPENING DETAIL

SECTION A-A

SECTION NOT TO SCALE

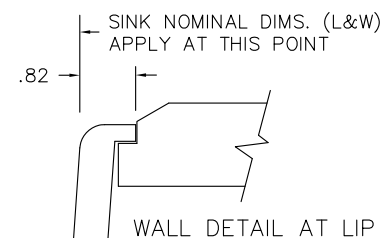

WALL DETAIL AT LIP

DETAIL NOT TO SCALE

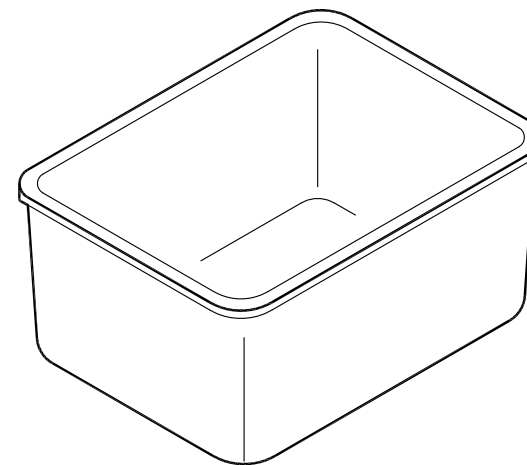

ISOMETRIC VIEW

"DIMENSIONS ARE NOMINAL, PROVIDED FOR PLANNING PURPOSES ONLY.  
CONTACT DURCON FOR RECOMMENDED SINK CUTOUT DIMENSIONS TO INSURE A QUALITY INSTALLATION."

SINK

WEIGHT

OUTLET LOCAL.

CODE

D55

61 LBS

CORNER

SNKD-55-\*\*

**FACTORY  
TAYLOR TX**

DATE: 04/27/10  
SCALE: 1=1  
DRAWN: RMJ  
FILE: D55.DWG

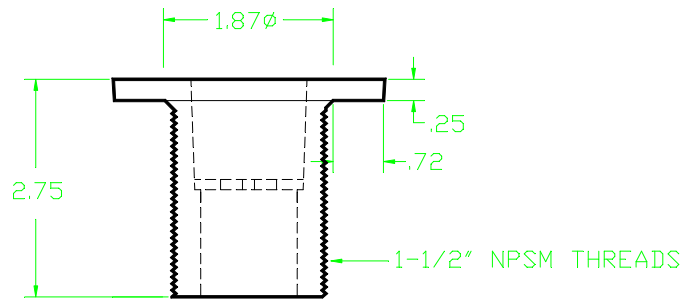

FRONT VIEW

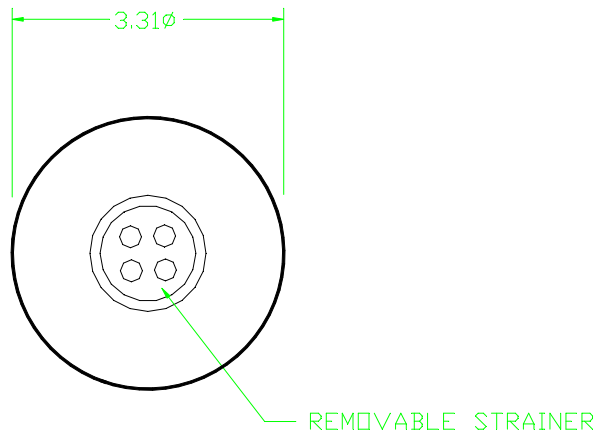

TOP VIEW

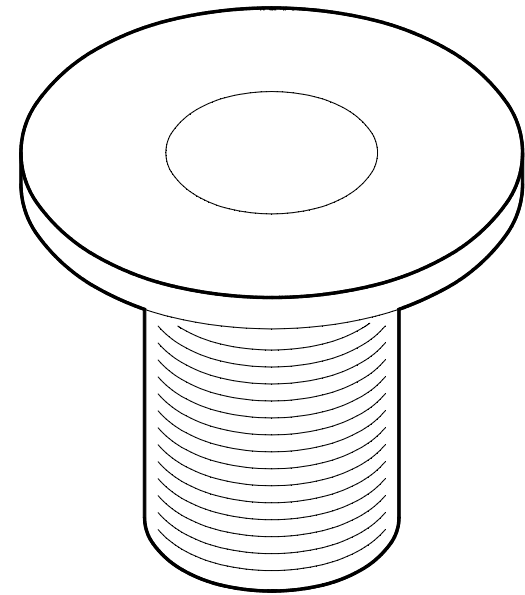

ISOMETRIC VIEW

SINK OUTLET

SINK	WEIGHT	OUTLET LOCAL.	CODE
SO-3R	.5 LBS	CENTER	SO-3R



REV. #\_\_\_\_  
DATE: \_\_\_\_\_

DATE: 01/25/06  
SCALE: N.T.S.  
DRAWN: KJR  
FILE: SO-3R.DWG